

PREP YOUR BUSINESS and EQUIPMENT ROOM

Your guide to a hassle-free installation

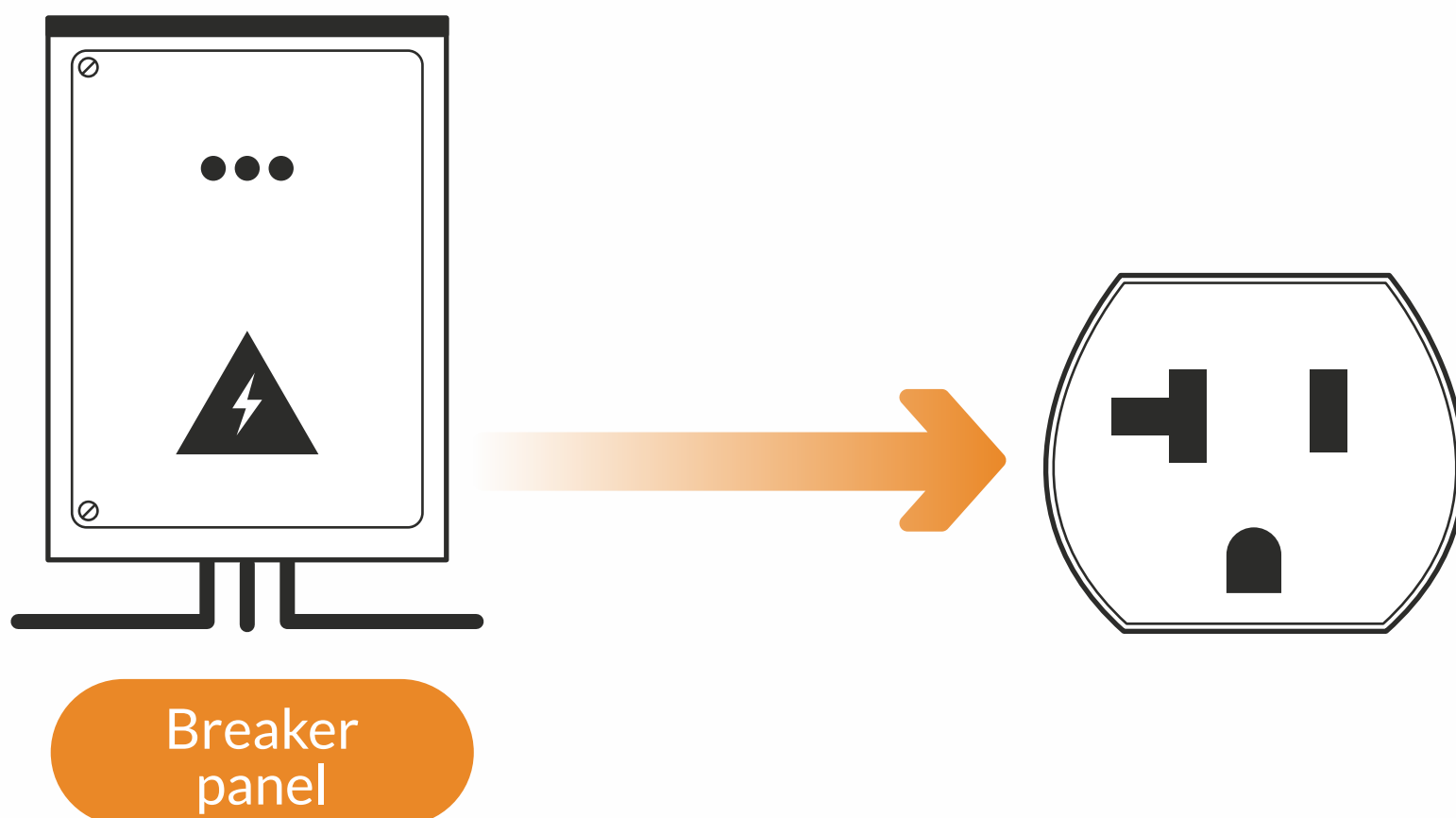

Having your *power ready* is critical for the date of installation.



Prep your T-Max system before installation!

1 Determine how many equipment rooms need to be prepped.

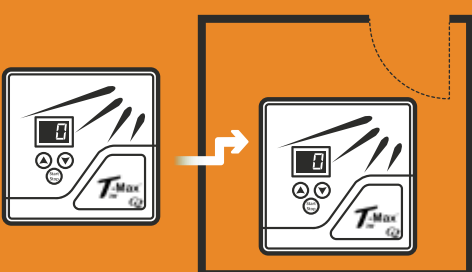

For 2 or less rooms use a front desk to room connection.

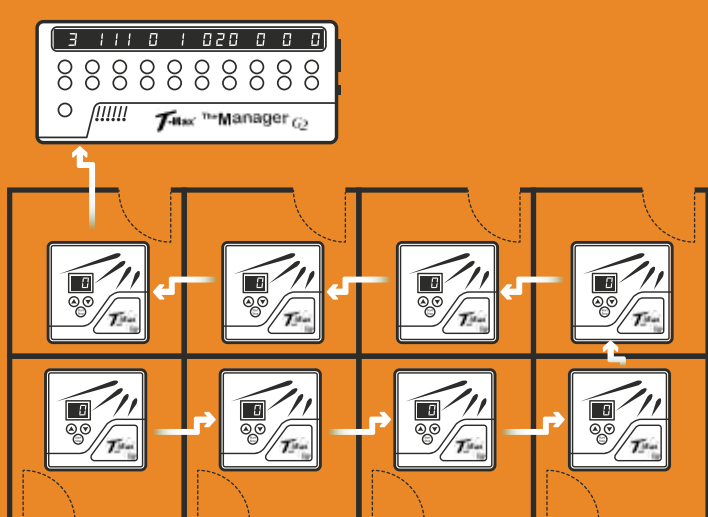

For more than 2 rooms use a daisy chain connection.

2 Purchase the proper materials.

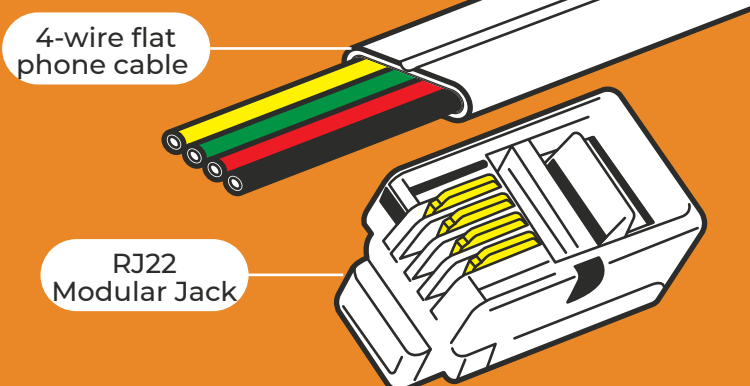

Purchase T-Max cable from ProSun or get 4-wire flat phone cable with RJ22 modular jack.

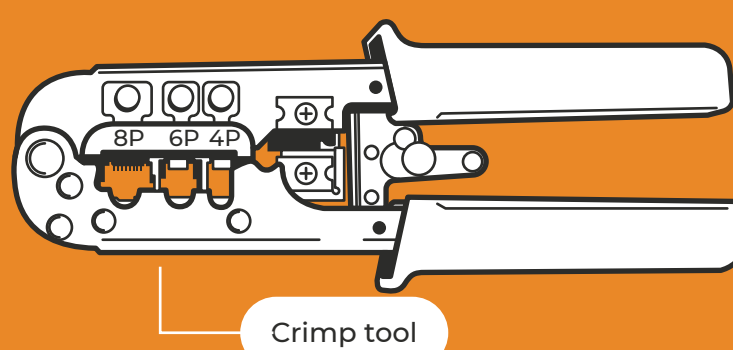

If getting your own cable get the RJ22 crimp tool. Make sure you put the ends in a straight wire pattern (where the wires line up the same on each end where the jack is crimped on).

! Bad crimp = faulty T-Max connections

3 Run the cable connections.

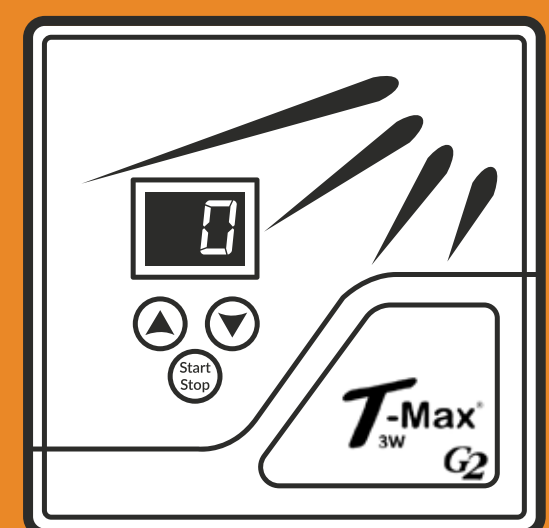

All T-Max cables must be ready and in place prior to installation.

For single room : Start at front counter and run to the individual rooms, clearly labeling the room #'s.

For daisy chain : Start at front desk to room 1, room 1 to room 2, room 2 to room 3, room 3 to room 4 etc.

! Room configuration may differ based on room #'s or location. Cables should start at front counter and make a logical path to the last room in the chain.

Let's get your equipment room

READY!

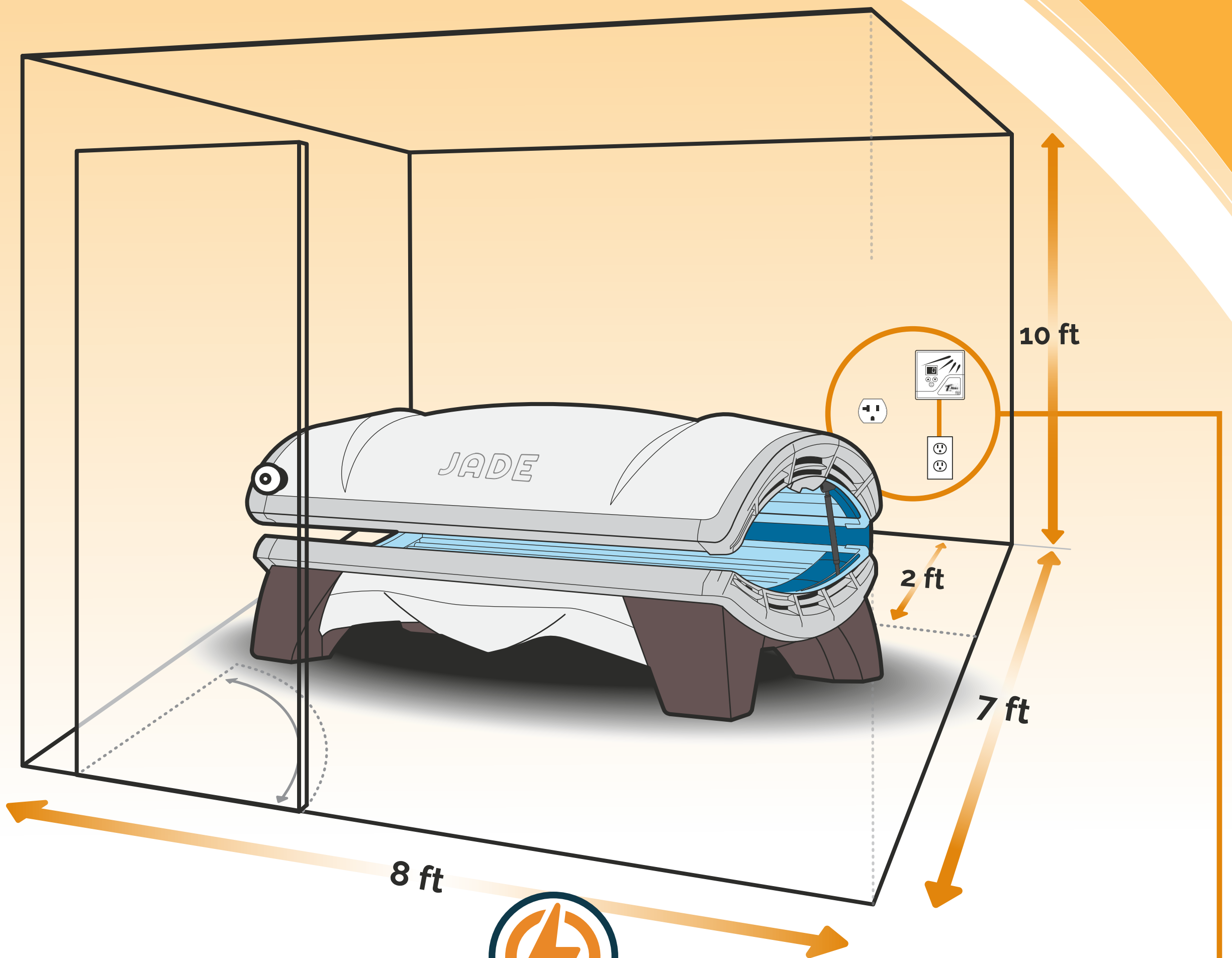

Prosun Jade Models

- Recommended room size: 8ft x 7ft
- AC requirements: BTU 6000 A/C
- Breaker size requirements: Single Phase - 20amp
- 110V Outlet required for T-Max



T-Max can be located to the side the unit where it is accessible to customers to override the delay time.

Disclaimer: All information provided is a suggestion for best layout but you must verify with your local electrical codes for approval.

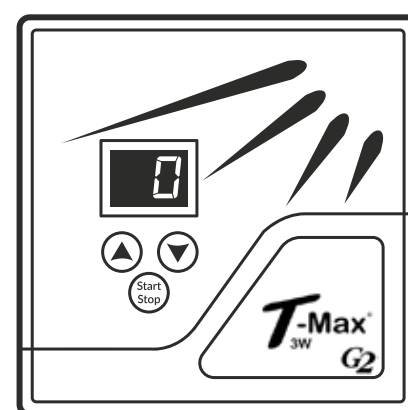

120V
20 Amp

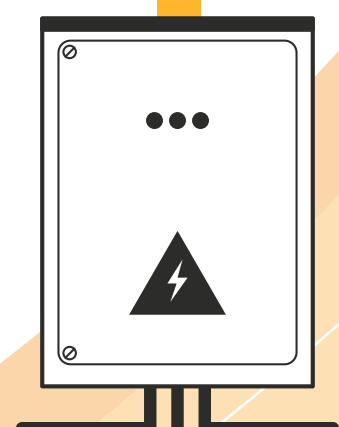
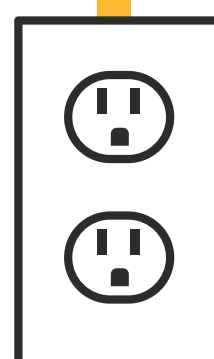
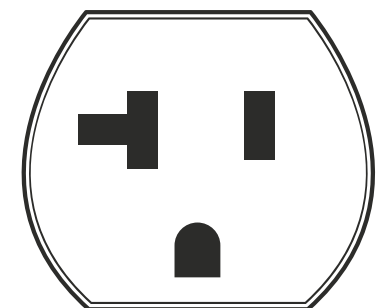

Contact Us

☎ 440.937.7775

✉ info@suntamsupply.org